

FES

Bianco - Argento - Grigio - Menta - Verde - Blu - Cielo - Nero



 **ASCOT**
EVERYTILE

RIVESTIMENTO / WALL
BIANCO - 13x13 / 5"x5"



RIVESTIMENTO / WALL
ARGENTO - 13x13 / 5"x5"



RIVESTIMENTO / WALL
GRIGIO - 13x13 / 5"x5"



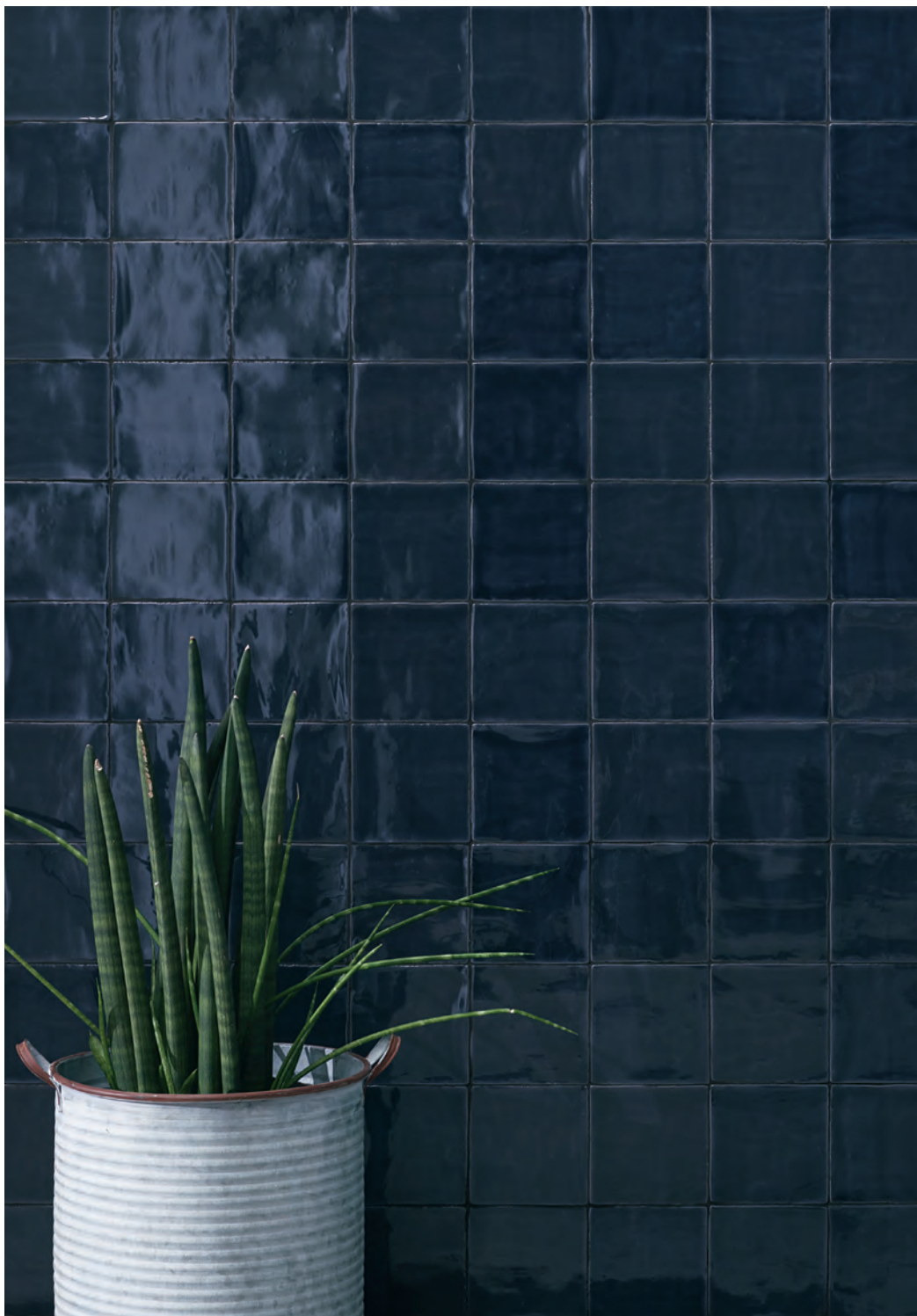

RIVESTIMENTO / WALL
BLU - 13x13 / 5"x5"



RIVESTIMENTO / WALL
NERO - 13x13 / 5"x5"

→
RIVESTIMENTO / WALL
VERDE - 13x13 / 5"x5"



FES



RIVESTIMENTO / WALL
DECORO 13x13 / 5'x5'

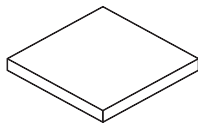

DECORO
CC0005146
13x13 / 5'x5'
9mm - Lux
30 pz

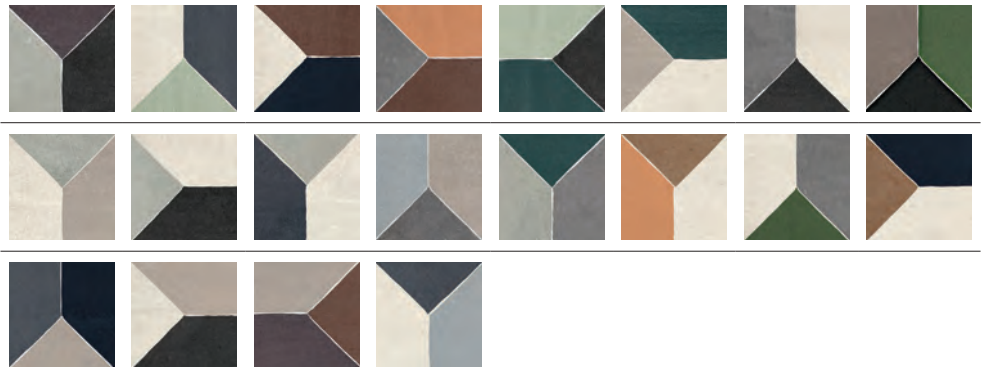

FES



RIVESTIMENTO / WALL
MENTA - 13x13 / 5"x5"

MONOCOTTURA IN PASTA BIANCA
WHITE BODY SINGLE-FIRED WALL TILE

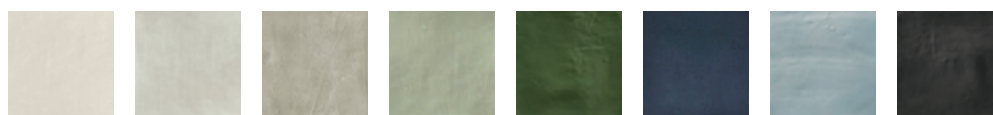

BIANCO ARGENTO GRIGIO MENTA VERDE BLU CIELO NERO

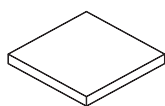

13x13 / 5"x5"
9mm - Lux

 30 pz

CC0005126 CC0005294 CC0005141 CC0005292 CC0005291 CC0005144 CC0005289 CC0005145

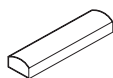

COPRISPIGOLO
1,5x13 / 0,5"x5"
9mm - Lux

 18 pz

CC0005295 CC0005302 CC0005296 CC0005301 CC0005300 CC0005297 CC0005299 CC0005298

IMBALLI /

Packing

| FORMATO SIZES | PZ./SCATOLA PIECES/BOX | MQ./SCATOLA SQM/BOX | KG./SCATOLA KG/BOX | SC./PALLET BOXES/PALLET | MQ./PALLET SQM/PALLET | KG./PALLET KG/PALLET | SPESSORE THICKNESS | UM |
|-------------------------------|---------------------------|------------------------|-----------------------|----------------------------|--------------------------|-------------------------|-----------------------|----|
| 13x13 / 5"x5" | 30 | 0,500 | 6,90 | 114 | 57,00 | 802 | 9mm | Mq |
| COPRISPIGOLO 1,5x13 / 0,5"x5" | 18 | - | - | - | - | - | 9mm | Pz |

DATI TECNICI /

Technical data

MONOCOTTURA IN PASTA BIANCA / WHITE BODY SINGLE-FIRED WALL TILE

Norma di riferimento: EN 14411 BIII

| CARATTERISTICHE TECNICHE TECHNICAL DATA | NORME NORMS | VALORI VALUE |
|---|----------------|--------------------|
|  Assorbimento d'acqua Water absorption | ISO 10545 - 3 | 16% |
|  Resistenza all'attacco acido e basico Glaze resistance to acid and alkaline attack | ISO 10545 - 13 | ≥ B |
|  Resistenza alle macchie Stain resistance | ISO 10545 - 14 | 5 |
|  Resistenza al cavillo Crazing Resistance | ISO 10545 - 11 | RESISTE RESISTS |
|  Stonalizzazione Shading | - | V2 |

In copertina colore Cielo
On cover, Cielo color

 **ASCOT**
EVERYTILE

A Brand of:  VICTORIA PLC



SEDE LEGALE E OPERATIVA:
Via Croce, 80
41014 Solignano di Castelvetro (MO) Italy
Tel: +39 059 77 84 11
Fax: +39 059 77 84 44/43
info@ascot.it - ascot.it